

# FOUNTAIN 250

IP68 **LANDSCAPE**

Sophisticated and robust design,  
The body is made from marine grade Stainless Steel 316  
RGB, RGBW or RGBA are available,  
Safe voltage: 12V DC.



RGBW



RDM



Dimmable



Extreme Environments



IP68



Easy Installation

## SPECIFICATION

MODEL	▶ FOUNTAIN 250
OPERATING VOLTAGE	▶ 12V DC
POWER CONSUMPTION	▶ 35W (Underwater Only), 45W (Underwater Only)
LED TYPE	▶ High Power LED
COLOR RANGE	▶ 2700K,3000K,3500K,4000K,5000K,RGB,RGBW,RGBA
SYSTEM EFFICIENCY	▶ 83lm/W@3000K
FWHM	▶ 6°, 12°, 20°, 30°, 45°, 10°*40°
MATERIAL	▶ Stainless Steel 316 + Tempered Glass
OPERATING TEMPERATURE	▶ -20°C ~ +55°C
STORAGE TEMPERATURE	▶ -25°C ~ +60°C
LIFE TIME	▶ 50,000 hours/L70 at 25°C
CONNECTION	▶ Quick-Plug
DIMENSIONS	▶ Φ250*79(H)mm
CABLE LENGTH	▶ 3000mm
WEIGHT	▶ 2.2kg
WATER PROOF	▶ IP68
SUBMERSIBLE DEPTH	▶ 3000mm Max
CONTROL	▶ ON/OFF, DMX, 0-10V Dim
LIST	▶ CE

ORDER CODE	MODEL	POWER	CCT	CRI	OPTICS	VOLTAGE	CONTROL	ACC
EXAMPLE	FOUNTAIN 250	- 35	- 3000K	- 80	- 12	- 12	- DMX	

# DIMENSIONS

Unit: mm

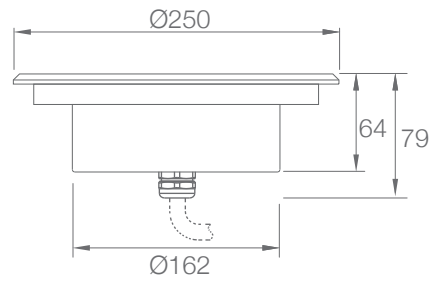
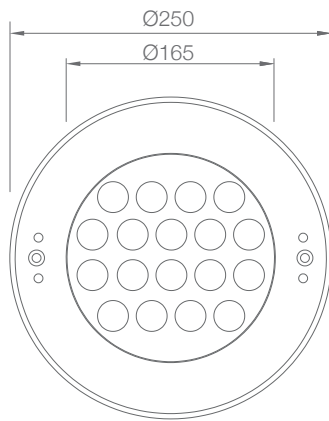

Suggest 15 mm space for cable

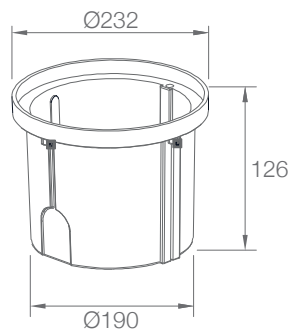

Pre installation Kit(PIKS)

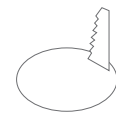

Cut Out 232mm

\* Tilt 5°, 15°, 25° beam angle available

# OPTIC SELECTION



6°

LED	Lumens	Watts	Efficacy
WHITE	2773.05	35.00	79.23

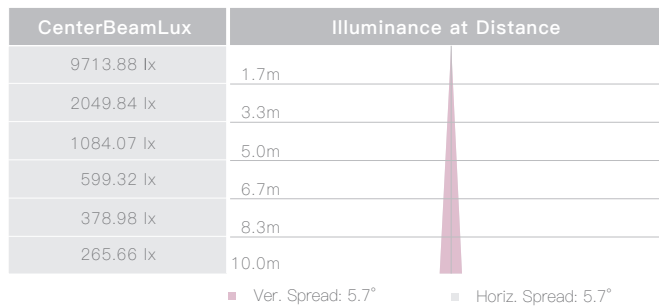

3000K



45°

LED	Lumens	Watts	Efficacy
WHITE	3740.40	45.00	83.12

